

Lights by :

UNISER

INDUSTRIES PVT. LTD.

LED LIGHTING | SOLAR POWER | SMART AUTOMATION

X

Lighting Design by :

LDI

Lighting Designers India
Architectural Lighting Consultant

Complete Architectural Lighting & Design Services



Philosophy

Uniser-LDI offers a full array of lighting design services suited to compliment any project type. By integrating our experience, technological awareness and innovative creativity, we delivers fresh and viable lighting solutions to our clients through light as the subject in creating a healthy environment that can uplift the end-user's sense of well-being.

We consider lighting isn't just to lightup. We believe lighting is an artwork and can transform any space into a beautiful art. We works very closely with the interior design and architectural teams on projects to advise on the functional aspects of lighting as well as the aesthetic impact required by the project and by the client. Every project is different but the relationship between lighting, interior and architecture is an enduring bond.

Strategy Planning!

Whilst similar to the concept proposal a lighting strategy would take the process a stage further identifying generic fixtures and lamp types which can be referred to for future development along with a set of rules to ensure future compliance.

We ensure that the lighting system provides ambient illumination for orientation and general tasks in the space, task illumination for local, more demanding tasks, and accent illumination to highlight special objects of interest or to guide occupants.

As a fact lighting design is not just calculation of lux level , it is dramatically linked to interior design and architectural design. The main challenge in lighting design is how to emphasize the texture, shadow, highlight, glow, and create the accent of interior lighting to pop-up displayed products as well as interior design.

Strategies

Light plays an essential role in our ability to perceive the world around us. The lighting system plays a critical role in how we perceive a space and can even influence how we act in that space. Lighting can affect performance, mood, morale, safety, security and decisions.

The first step in producing the right lighting design is to ask what the space is used for. The lighting designer can then determine quantity of light, color quality, brightness and direction.

It is beyond the scope of this article to go step by step through the process of producing a lighting design. Instead, we will review the several ways that lighting professionals look at lighting design, from the simple to the sophisticated.

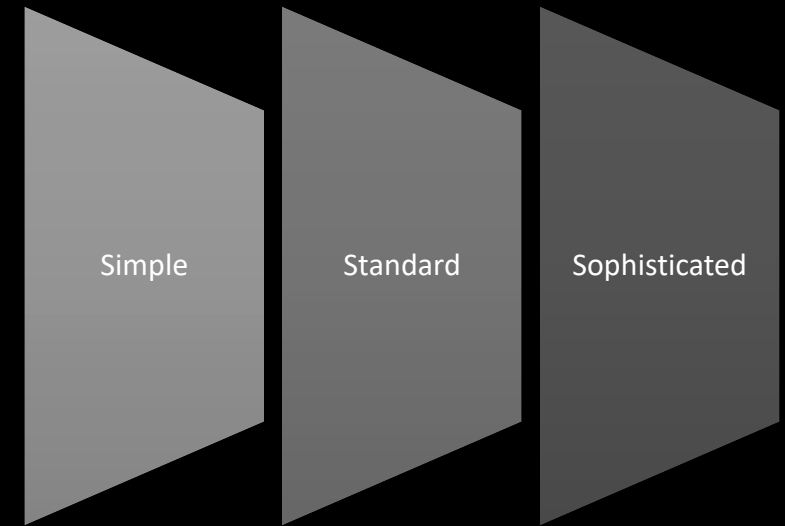

Lighting Strategic Applications

Key Lighting



Fill Lighting



Silhouetting



Up Lighting



Sparkle & Glitter Lighting



Wall Grazing Lighting



Wall Washing Lighting



Services

From initial strategic advice and concept development all the way through to construction documents and on-site support, we offer unparalleled creativity backed by the technical excellence and experience for which we are renowned. Our team are experts in daylight design, light and wellbeing, fixture design, brand identity and lighting engineering



Lighting Strategies



Dimming & Lighting Automation



Lighting Master Planning

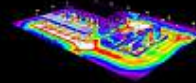

Lighting Simulation & Analysis



Ecological Luminaire Selection



Realistic Rendering & Visualization



Luminaire Calculations,
ROI & Energy Savings



Lighting Specifications



Lighting Advisory

- Lighting design
- Product Specifications
- Site Survey & Analysis
- Investigate the existing scenarios
- Considering the daylight for retrofit
- Make cautious lamp choices
- Lower Light Levels
- Enabling Multipurpose Lighting Solutions
- Design / Customize Lighting Controls
- Optimizing Lighting Systems suitability & feasibility
- Examining financials & ROI

Lighting Design Package

Concept, Development, Specification and Implementation in one complete lighting design package.

Lighting Designers India will design, follow and supervise the entire process ensuring the finished lighting scheme is in line with the original concept proposal

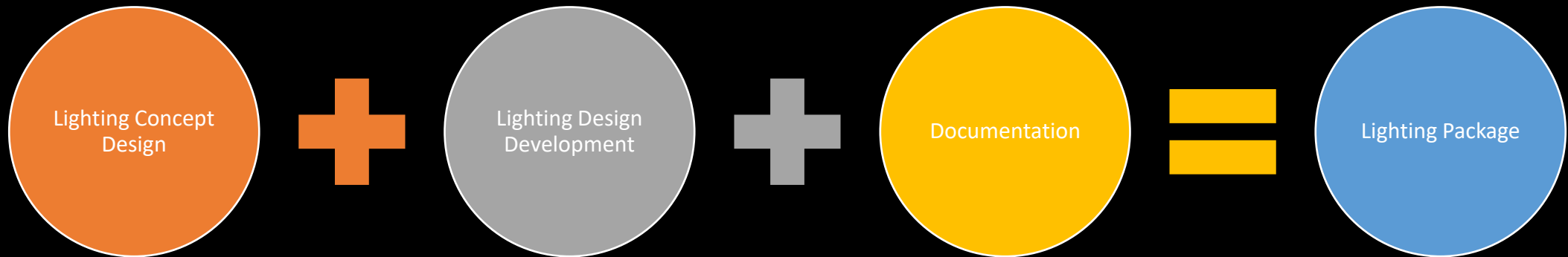

Lighting Analysis

The lighting conditions under which will operate the building users represent a key-aspect for the interior environmental quality. The sustainability protocols currently in-use try to increase the use natural illumination because, apart from the eventual energy savings, the artificial light has a much lower frequency compared with the sun light and therefore it turn out being non-optimum for the human eye perception.

In order to guarantee optimum lighting conditions, even during the early design stage it is important to develop a simulation of the natural and artificial lighting conditions which could help us identifying possible weak points where light lacks or exceeds. On the other side, lighting simulation allows us to evaluate the efficiency of shading devices and their effects on lighting conditions.

Lighting Concept
Product Selection
Lighting Simulation
Lux Study
Analysis Report
3D Renders
Realistic Visualization
Electrical Load Analysis
Economical Solutions
Cost Saving Design
Concept Renders
Product Specifications
Photometric Files
Technical datasheets / cutsheets
CAD Drawings
DB / Wiring Drawings
All the documents in PDF Format

Reporting

Calculations & renders, reports

The image displays five overlapping screenshots from a lighting design software interface, illustrating the reporting and visualization capabilities for 'Outdoor space 1'.

- Summary Report:** A table titled 'Outdoor space 1 Summary' showing calculation results. The 'Results' section includes a 'Check' column with green checkmarks, indicating that the calculated values meet the target and comparison values.
- 3D Render:** A 3D perspective view of the outdoor space, showing the layout of the area and the placement of lighting fixtures.
- 3D Light Distribution:** A 3D visualization showing the light distribution across the space, with a color gradient from blue (low light) to red (high light).
- 2D Floor Plan:** A 2D floor plan view of the outdoor space, showing the layout of the area and the placement of lighting fixtures. The title is 'Outdoor space 1 Workplane (Outdoor space 1)'. It includes a table with columns for 'Target', 'Calc', 'E', 'D', and 'Index', showing values for the 'Workplane'.
- 2D Light Distribution:** A 2D visualization showing the light distribution across the space, with a color gradient from blue (low light) to red (high light). The title is 'Lobby Area'. It includes a table with columns for 'Target', 'Calc', 'E', 'D', and 'Index', showing values for the 'Lobby Area'.

Realistic Rendering & Visualization

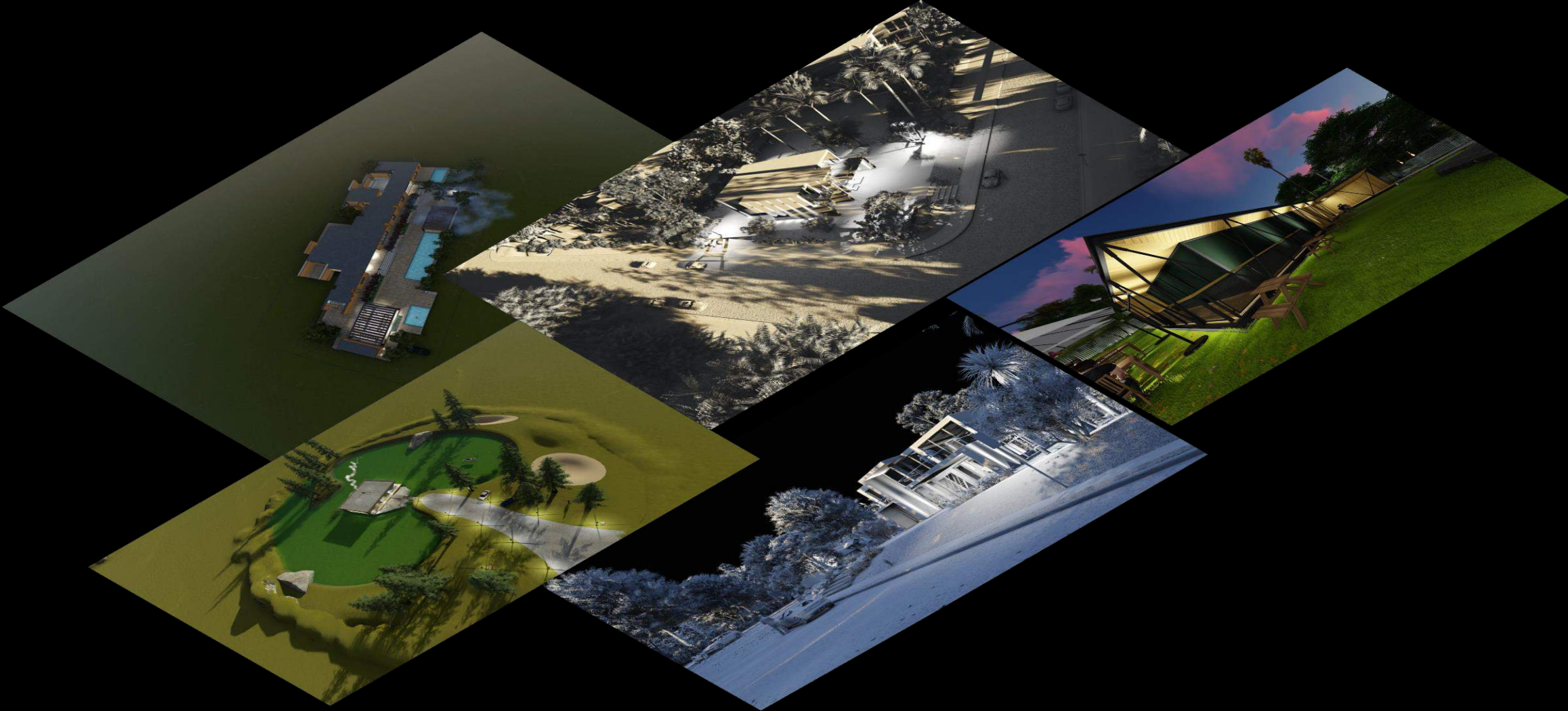

Projects

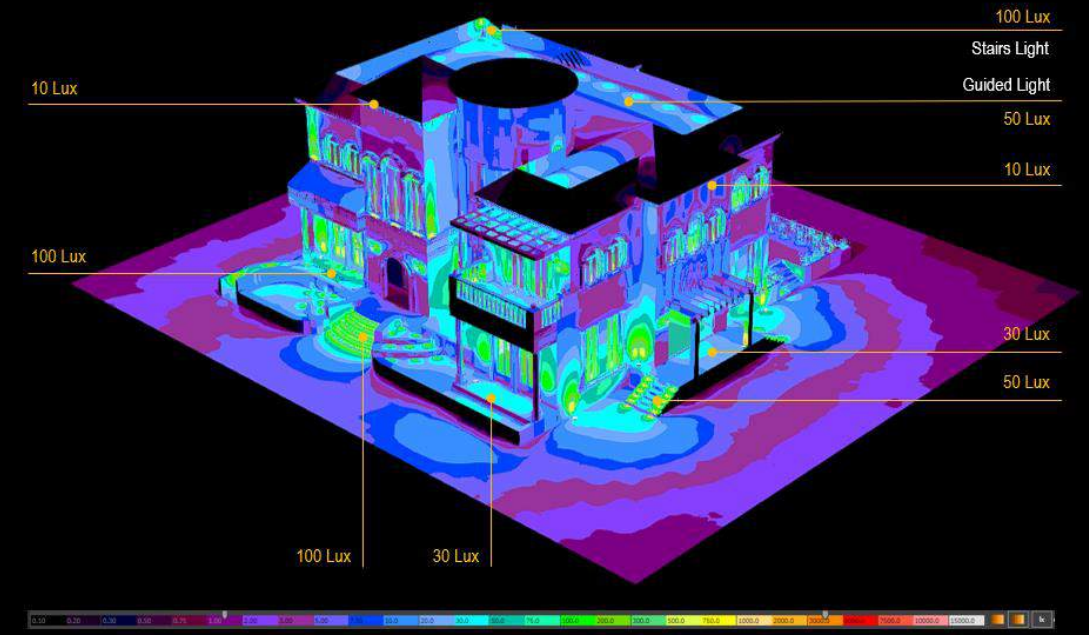
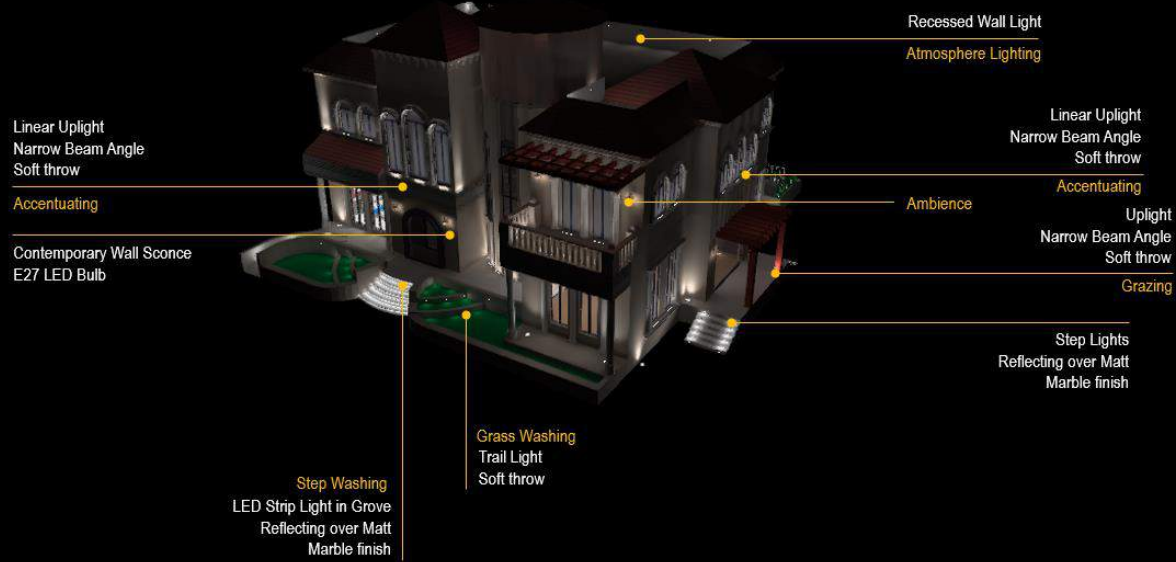

Project Brief:

The aim of this project was to plan an architectural resemblance with the natural reflection of the precious stones used as cladding on this classic villa, and lighting up the Façade without affecting its natural glow of the stone and create a drama that can highlight the crown finish as a design tool.

ld Private Villa, Dubai



[d] Private Villa, Sharjah





[d] V3 Tech Solutions, Hyderabad



[d] Hotel Fairway, Colombo, Sri Lanka



[d] Multiple Projects across Hyderabad



[d] Private Villa, Dubai



 Private Residence, Melbourne, Australia



[d] Pranava Business Park, Hyderabad



 Mikel Store, Qatar

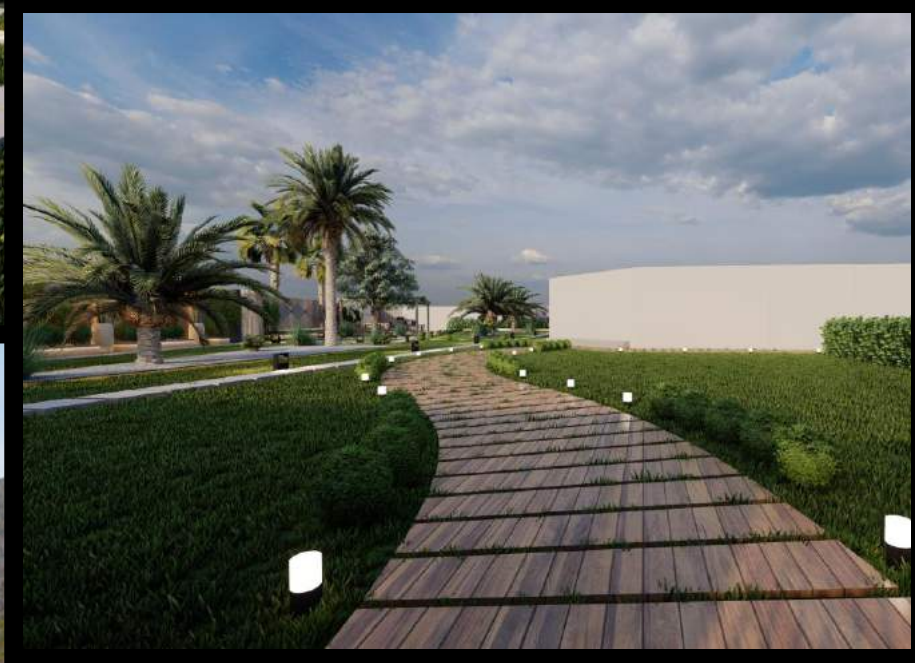

[d] Private Villa Landscape Lighting, Saudi

Lights by :

UNISER

INDUSTRIES PVT. LTD.

LED LIGHTING | SOLAR POWER | SMART AUTOMATION

X

Lighting Design by :

LDI

Lighting Designers India
Architectural Lighting Consultant

Complete Architectural Lighting & Design Services

Follow us:



www.uniserledlights.com
projects@uniserledlights.com

Address:

Uniser Industries Pvt Ltd
414, Lotus House, New Marine Lines,
Mumbai 400020, MH, India



+91-22-35114465



+91-9867625686

UNISER

INDUSTRIES PVT. LTD.

LED LIGHTING | SOLAR POWER | SMART AUTOMATION